

# MONSTER1215 MONSTER1215B

User's manual

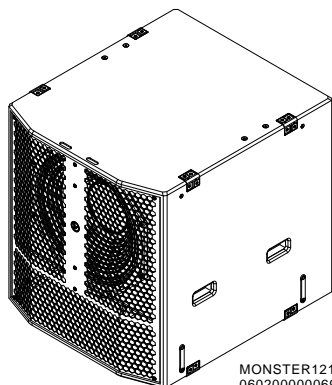

MONSTER121S(A1)  
06020000069001(white)

MONSTER121SB(A1)  
060200000179001(black)

## MONSTER121S

**Description:**subwoofer 1x21"

**Low frequency limit:**

(-10 dB) 23Hz (processed)

**Maximum SPL:**140dB (processed)\*

**Nominal impedance:**8

**Transducers:**

21" ferrite magnet aluminum ring  
die cast basket

**Acoustical load:**bass-reflex

*\*Peak level at 1 m under half space conditions  
using pink noise with crest factor 4*

The Monster121S uses an 21-inch high efficiency ferrite magnet ultra-low frequency driver with a 5-inch voice coil and long stroke. Due to the optimized design of the transducer cabinet and curved radiant tube technology, it can replay the 23 Hz (processed) limit frequency to obtain excellent radiation efficiency and excellent sound quality.

By relaxing the requirements for amplifier power, system costs can be reduced.

The front is equipped with a protective net for easy maintenance.

### Connect

2xNEUTRIK® NL4 SPEAKON® parallel  
INPUT/LINK: ±1Through ±2

### Cabinet

18mm birch plywood made by CNC  
Wear-resistant environmentally  
friendly polyurea spray paint

**Handling:**4 handles

**Front:**coated steel grille

**Finish:**White paint finish or black matte finish

**Product DIM(mm) / Package DIM(mm)**

W742xH796xD850 / L982xW874xH939

**N.W / G.W:**

85kg (187 lb) / 99kg (218 lb)

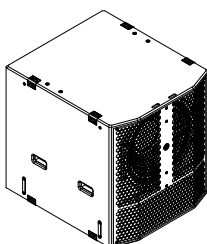
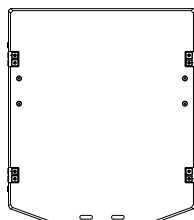
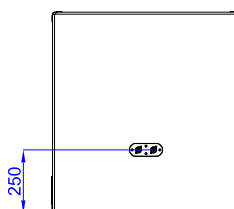
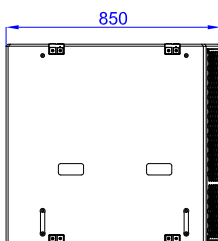
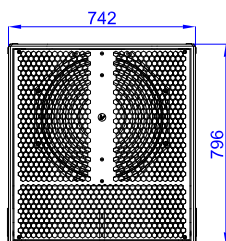

Standard system stack view

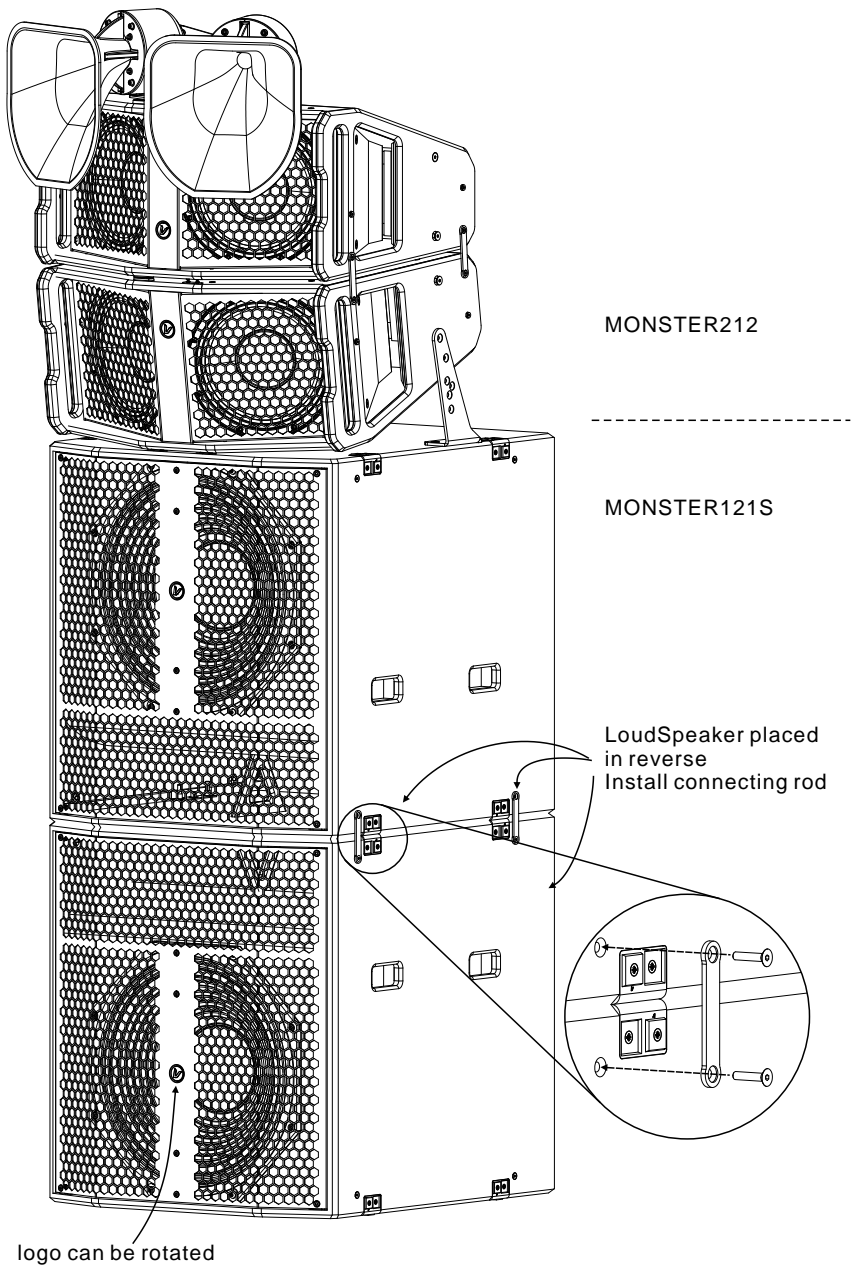

Verity Audio reserves the right to make any changes to the product specifications without prior notice.  
Final specifications to be found in the user manual.

